

MATERIAL

Aluminium. Oval cross section bar.

STANDARD EXECUTIONS

Threaded blind holes

- **GN 427-EL**: anodised aluminium, natural colour, matte finish.
- **GN 427-SW**: epoxy resin coating, RAL 9005 black colour, matte finish.

SPECIAL EXECUTIONS ON REQUEST

Different lengths and colours.

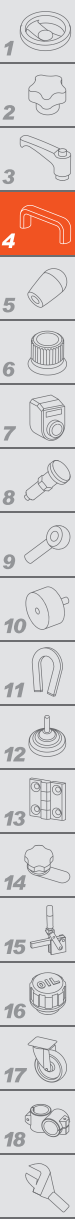

Conversion Table	
1 mm = 0.039 inch	
mm	inch
88	3.46
100	3.94
120	4.72
180	7.09
200	7.87
235	9.25

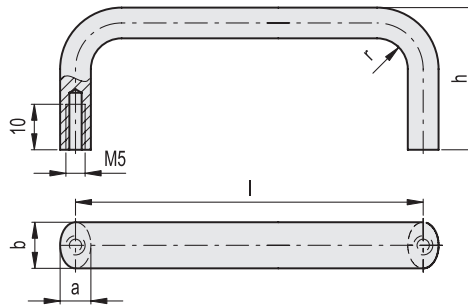

METRIC

Code	Description	b	l	a	h	r	⚖️
GN.27031	GN 427-12-88-EL	12	88±0.25	8	40	8	30
GN.27032	GN 427-12-88-SW	12	88±0.25	8	40	8	30
GN.27035	GN 427-12-100-EL	12	100±0.25	8	40	8	30
GN.27036	GN 427-12-100-SW	12	100±0.25	8	40	8	30
GN.27041	GN 427-12-120-EL	12	120±0.25	8	40	8	35
GN.27042	GN 427-12-120-SW	12	120±0.25	8	40	8	35
GN.27045	GN 427-12-180-EL	12	180±0.25	8	40	8	45
GN.27046	GN 427-12-180-SW	12	180±0.25	8	40	8	45
GN.27051	GN 427-12-200-EL	12	200±0.25	8	40	8	50
GN.27052	GN 427-12-200-SW	12	200±0.25	8	40	8	50
GN.27061	GN 427-12-235-EL	12	235±0.25	8	40	8	60
GN.27062	GN 427-12-235-SW	12	235±0.25	8	40	8	60

Lift & Pull handles